



LED Light Kit Installation Instructions - Drag Slash

Covers Part #9497, 9497A, 9497R, 9497X

Kit Contents:

- Tail lights wiring harness
- Power wire harness
- Tail light housings (left & right)
- Housing mounts (2)
- Rear trim (1)
- Rear trim retainer (1)
- Body trim templates
- 2.6x8mm button-head cap screws (4)
- 1.6x5mm button-head cap screws (5)
- Zip ties (3)
- Zip tie mounts (3)

Tools required:

- Tapered body reamer (part #3433 or #3433X, sold separately)
- Hobby knife
- 2mm hex wrench
- 1.5mm hex wrench
- Silicone grease (part #1647, sold separately)



CAUTION: RISK OF INJURY!

Use care with hobby knives, tapered reamers, and other cutting tools as they are extremely sharp and can cause severe injury, deep cuts, and/or punctures.

REAR TRIM AND TAIL LIGHT HOUSINGS INSTALLATION

1. Install the rear trim on the tailgate using the included 1.6x5mm button-head cap screws (5) (refer to Fig. 4 Assembly Diagram for more detail).
2. Install the tail light housings on the truck body using the included mounts and 2.6x8mm button-head cap screws (4).
3. Reinstall the rear bumper using the four 3x10mm button-head cap screws.

POWER WIRE HARNESS INSTALLATION

1. Remove the receiver box cover by removing the two 3x8mm button-head cap screws (Fig. 1).
2. Remove the wire clamp by removing the two 2.5x8mm cap screws.
3. Route the power wire harness into the receiver box and plug it into any open channel on the receiver. Position the power wire harness in a wire guide of the receiver box.
4. Apply a small bead of silicone grease (part #1647, sold separately) to the wire clamp foam. Install the wire clamp and tighten the two 2.5x8mm cap screws securely.
5. Make sure the blue O-ring seal is properly seated in the groove in the receiver box so that the cover will not pinch it or damage it in any way.
6. Reinstall the cover on the receiver box and tighten the two 3x8mm button-head cap screws securely. Inspect the cover to make sure that the O-ring seal is not visible (see Fig. 2 for completed installation).

Fig. 4

ASSEMBLY DIAGRAM

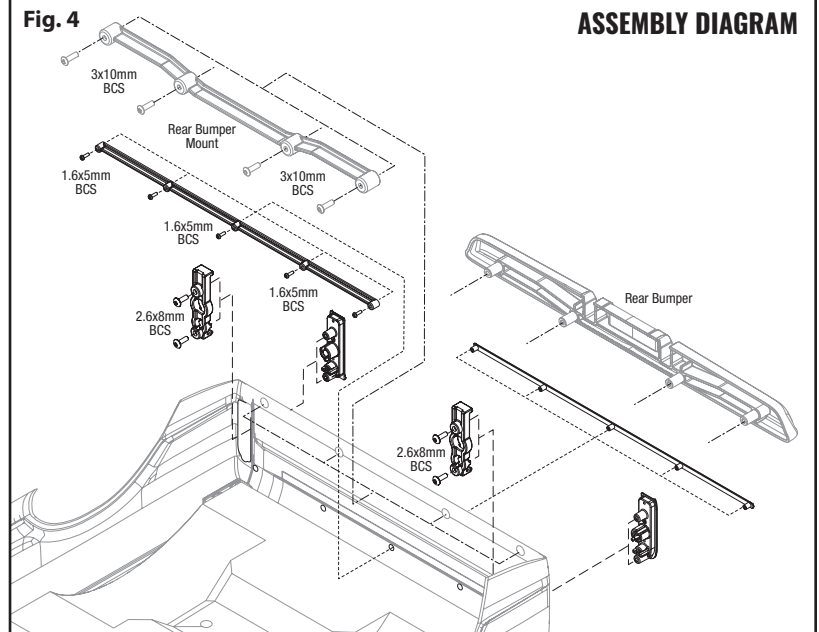

TAIL LIGHTS WIRING HARNESS INSTALLATION

1. Insert the LED tail lights into the receptacles on the tail light housings (refer to Fig. 5 Body Wiring Diagram for more detail).
2. Route the wire harness in the body; install the zip tie mounts (3) and use zip ties (3) to secure the wiring to the body with the mounts provided.

Fig. 5

BODY WIRING DIAGRAM

(viewed from the underside of the body)

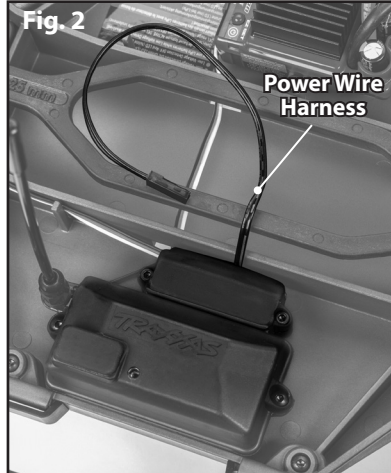
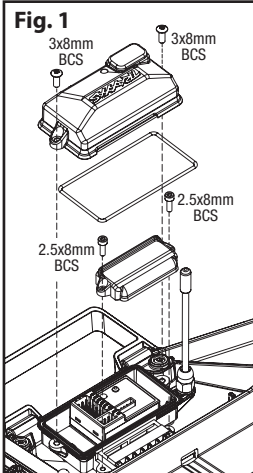
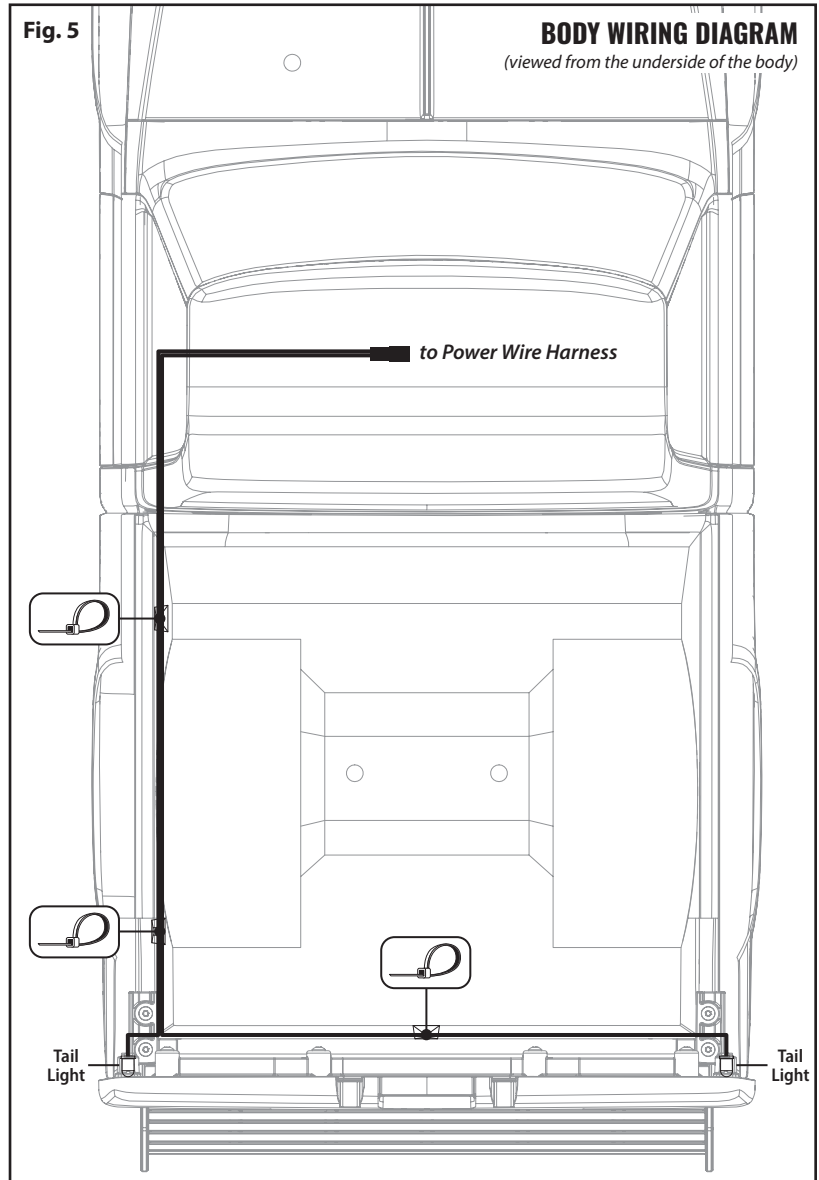

BODY MODIFICATION

1. Remove the rear bumper by removing the four 3x10mm button-head cap screws. Install the included body trim template on the truck body. Align the arrows with the body lines on the rear of the truck bed as shown in Fig. 3.
2. Using a tapered body reamer, carefully cut the holes in the truck body for the screw bosses on the tailgate rear trim retainer (note the hole diameters indicated on the templates and the corresponding diameter measurements on the body reamer).
3. Using a hobby knife, carefully cut out the holes in the truck body for the tail light assemblies.

