

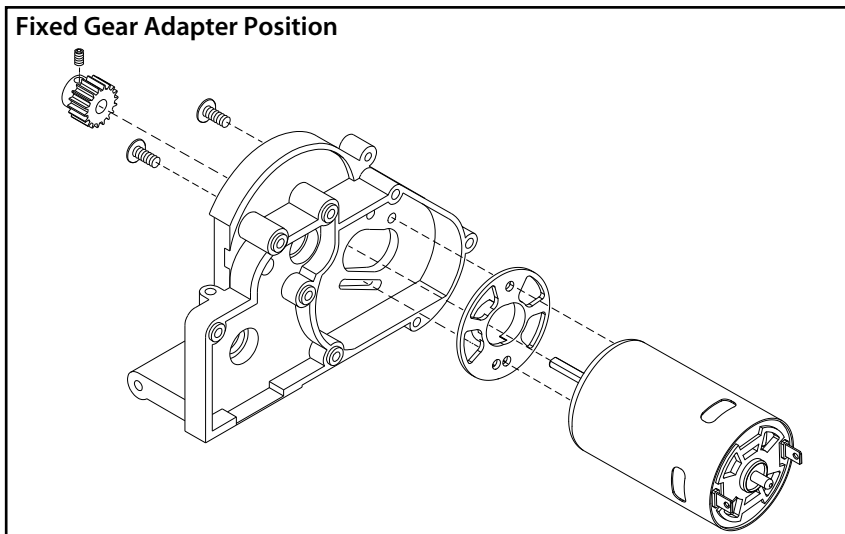

THE FOLLOWING GEAR RATIOS ARE ONLY RECOMMENDED FOR THE LISTED MODELS WITH THE STOCK POWER SYSTEM AND STANDARD TIRES

Covers Part #3790	STOCK GEARING			SPEED GEARING		
Model (Model No.)	Lower Motor Screw Position	Pinion	Spur	Lower Motor Screw Position	Pinion	Spur
<i>Bigfoot No. 1 (36034)</i>	B	14	90	D	19	90
<i>Bigfoot (36084)</i>						
<i>Craniac (36094)</i>						
<i>Skully (36064)</i>						
<i>Bandit (24054)</i>	B	21	83	None*	31	83
<i>Rustler (37054)</i>	C	16	90	None*	28	86
<i>Slash (58024)</i>	C	16	90	D	23	86
<i>Slash (58034)</i>						
<i>Slash (58094)</i>						
<i>Stampede (36054)</i>	C	16	90	A	21	90
<i>Slash VXL (58076)</i>	D	23	86	None*	28	86
<i>Bandit VXL (24076)</i>	E	26	76	B	28	76
<i>Stampede VXL (36076)</i>	F	19	86	A	25	86
<i>Rustler VXL (37076)</i>	G	25	83	A	28	83

*Do not use the fixed gear adapter when speed gearing is installed.

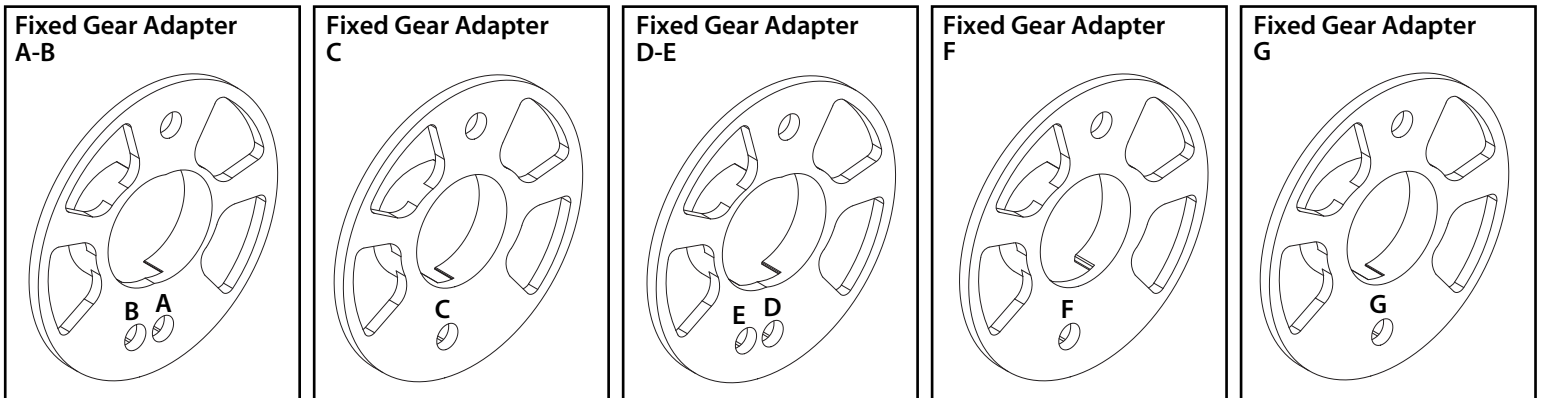

IMPORTANT!
After installation of the adapter, loosen the set screw and align the edge of the pinion gear with the edge of the spur gear as shown; retighten the set screw.

